







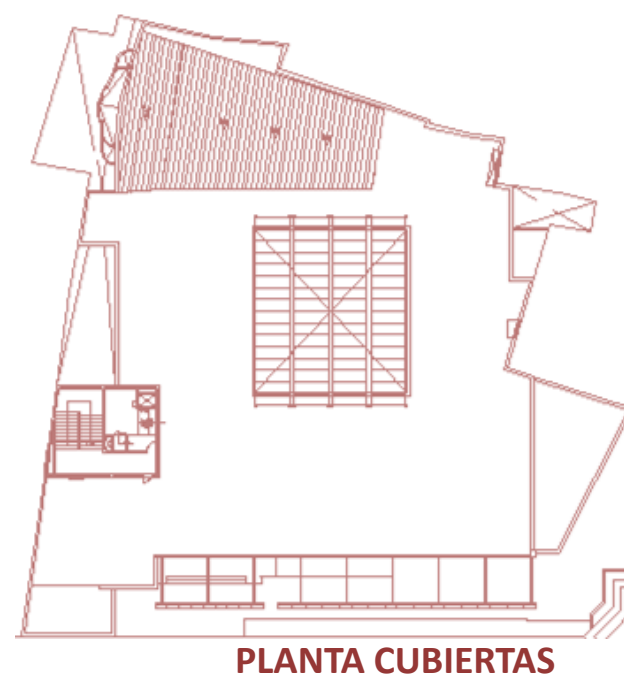
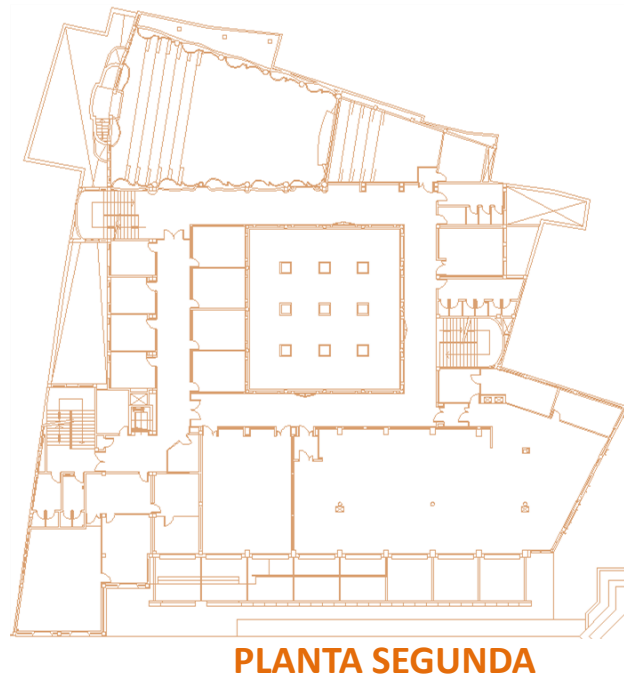
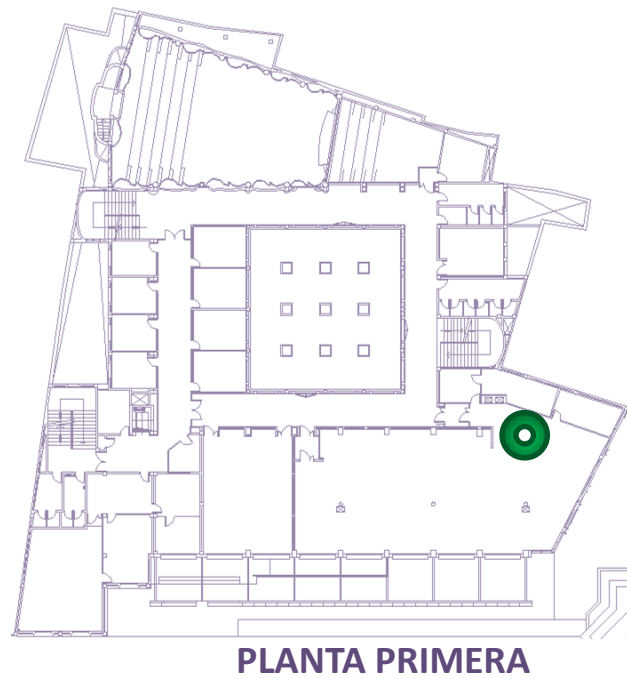
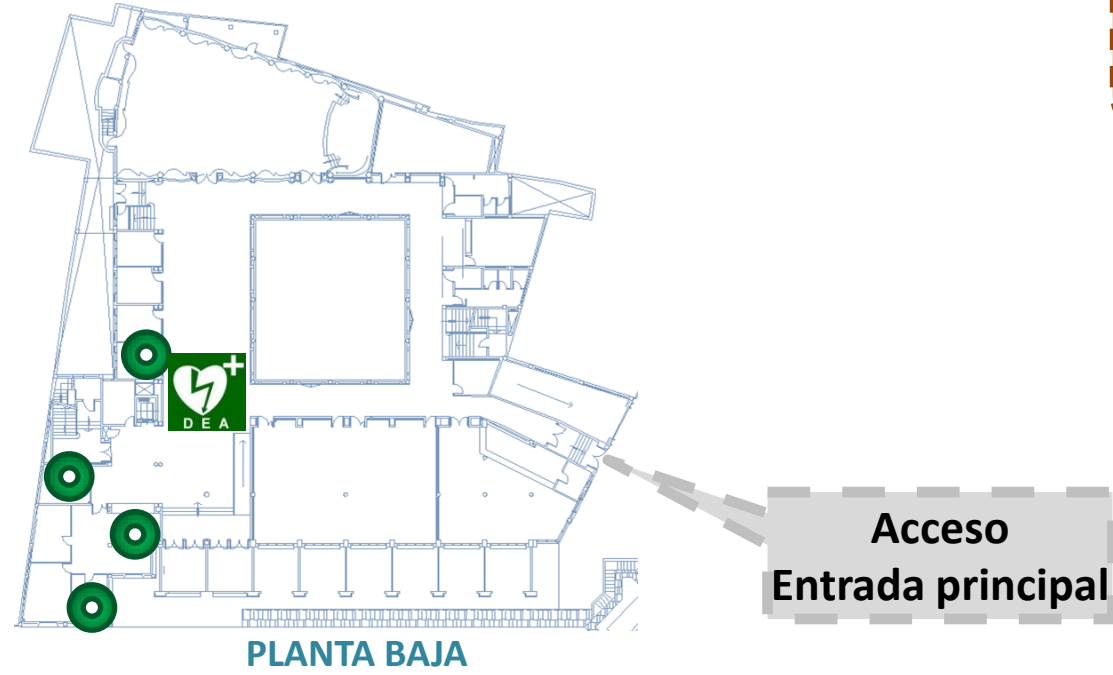
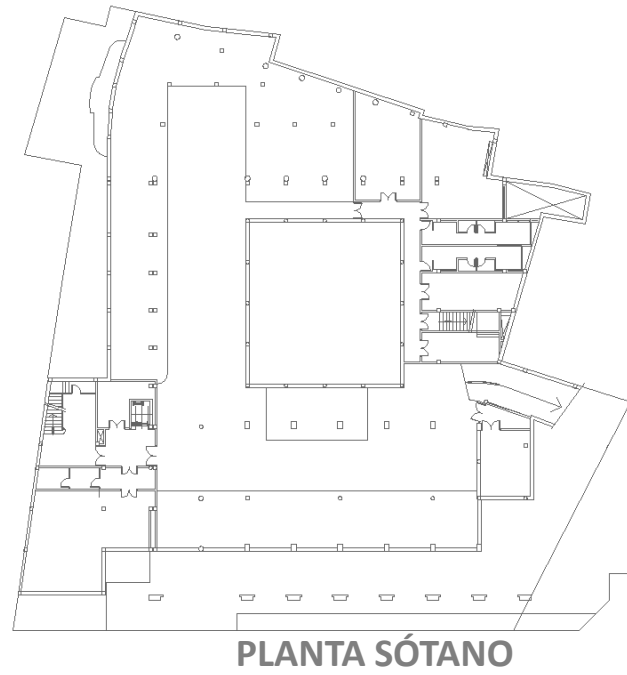

Ubicación de Desfibriladores Externos Automatizados (DEA) y personal formado en DEA

 **DEA existente**
 **Conserjería 957212525 (2525)**
 **Personal formado en DEA**



SI TE ENCUENTRAS UNA PERSONA CON PARADA CARDIORESPIRATORIA:

-  **Pide ayuda**
-  **Llama al 061**
-  **Contacta con el DEA  más cercano**
-  **Indica clara y exactamente tu nombre**
-  **Indica clara y exactamente tu ubicación**

