

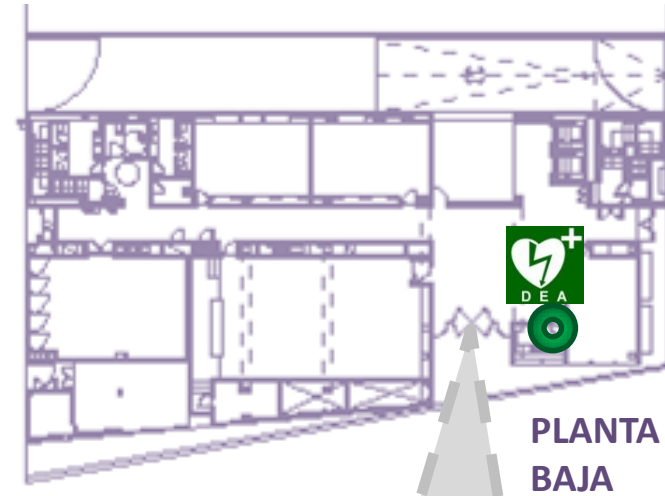

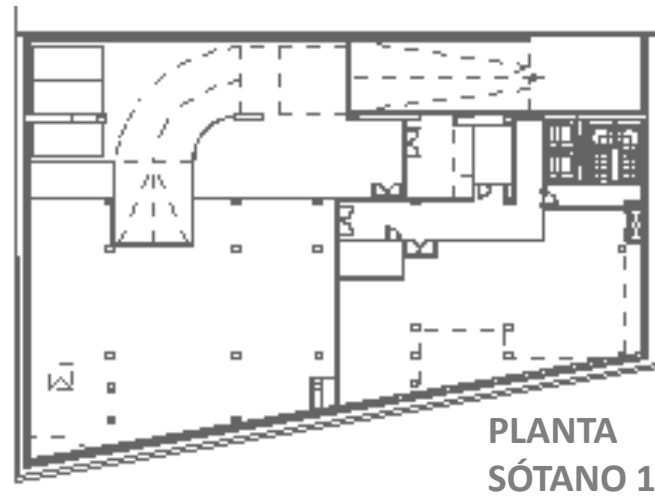

Ubicación de Desfibriladores Externos Automatizados (DEA) y personal formado en DEA

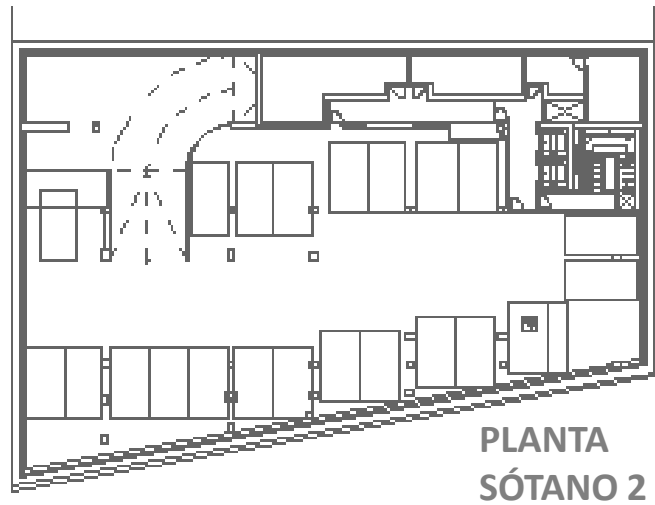

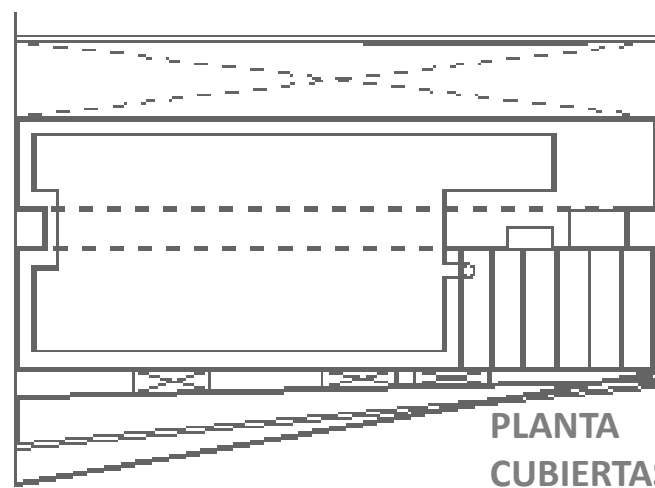
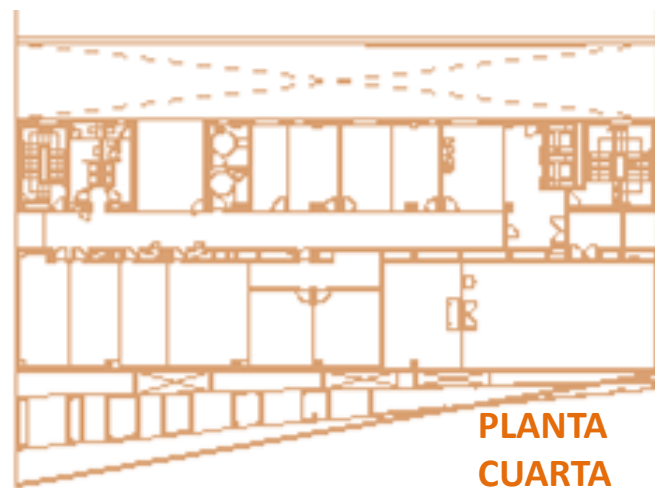
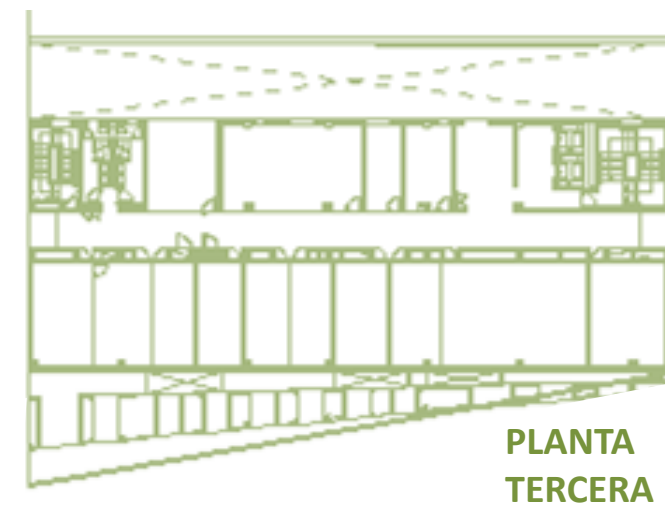
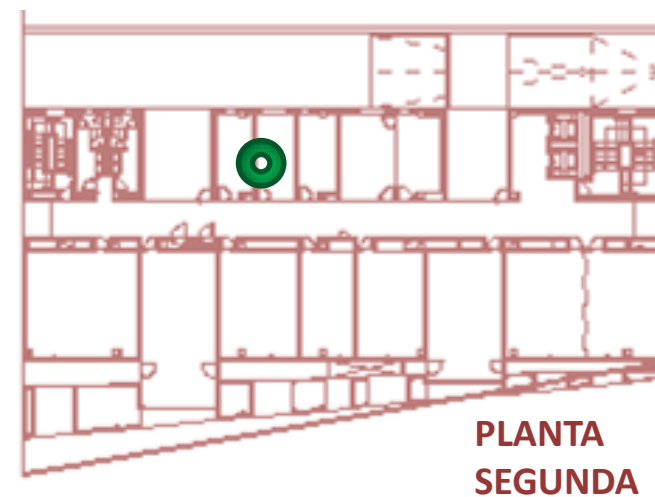
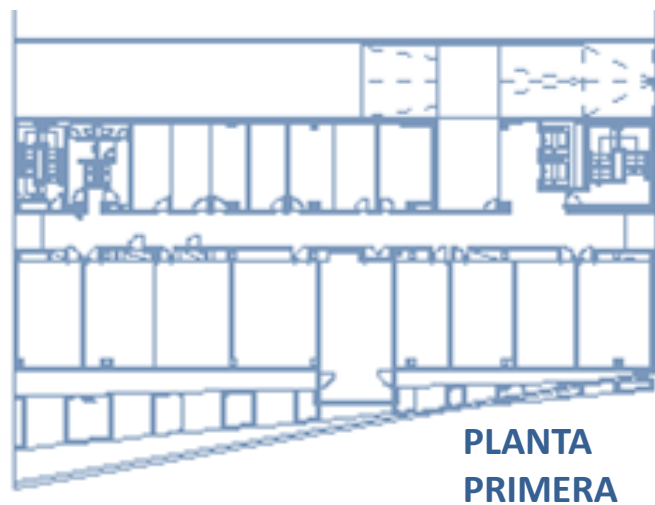





Acceso
Entrada principal



 **DEA existente**
 **Conserjería 957213100 (3100)**
 **Personal formado en DEA**

SI TE ENCUENTRAS UNA PERSONA CON PARADA CARDIORESPIRATORIA:

-  **Pide ayuda**
-  **Llama al 061**
-  **Contacta con el DEA  más cercano**
-  **Indica clara y exactamente tu nombre**
-  **Indica clara y exactamente tu ubicación**

SERVICIO DE PREVENCIÓN DE RIESGOS LABORALES	UNIVERSIDAD DE CÓRDOBA		
	Edificio: UCO-Vial Norte		
	ZONA CARDIOASEGURADA		
Escala: 0 		Fecha: 07/16	